



# **Vastu Aarambh**

online certificate course

## **Study Material**

Mangala Charan

मङ्गलाचरणम्

आनन्दं वो गणेशार्कविष्णुगौरीमहेश्वराः ।

देवाः कुर्युः श्रियं सौख्यमारोग्यत्वं गृहे सदा ॥ 1 ॥



## Day 2

1. Correct placement of rooms
2. Wrong openings
3. Best Door openings
4. Water boring & Over Head Tank
5. Types of Grids (Basic)
6. Plot Cut & Extention
7. Colour for zone
8. Floor Level
9. Stair placement
10. Kitchen placement
11. Zone qualities

ONLINE LEARNING



## Day 2

### Vastu Utilities

1. Aarti & Pooja
2. Entrance door light, space, dustbins,
3. Sharp corners
4. Air & Light channel
5. Wall Paper
6. Family photos
7. Curtain colours
8. Shoe rack
9. Carpet colours
10. Door and bed alignment
11. Bed back (top beam)
12. Under bed to be clear
13. Side table
14. Inspirational quotes
15. Laptop & TV usage
16. Reflection from objects
17. Color scheme basic all over house

ONLINE LEARNING



3X3 GRID

N  
0°

VASTU AARAMBH

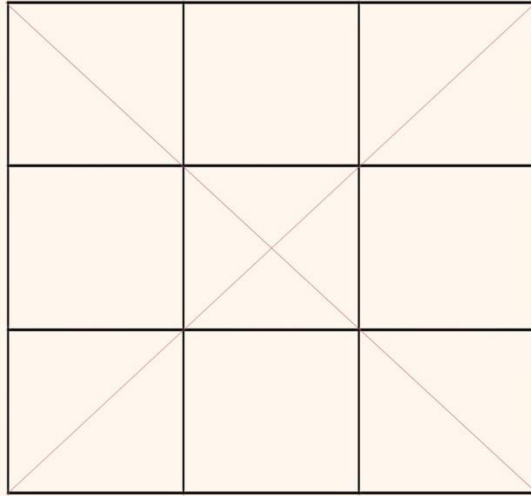

Room placement

N  
0°

VASTU AARAMBH

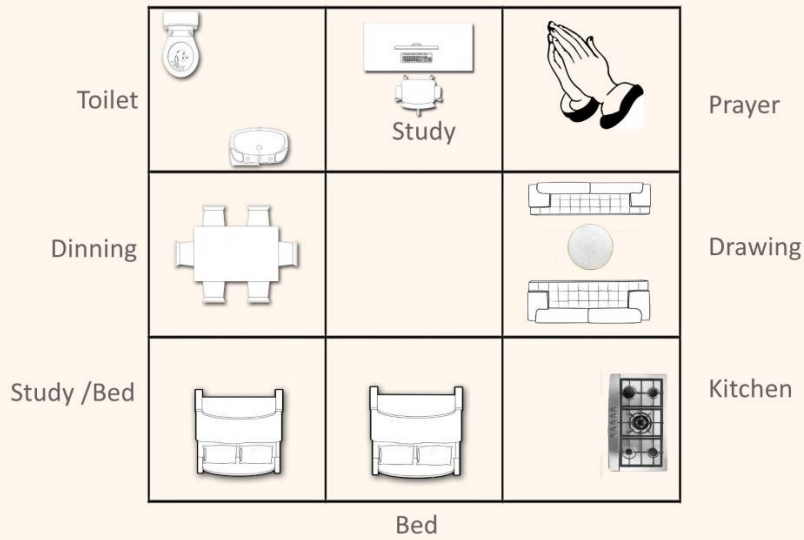

N  
0°

VASTU AARAMBH

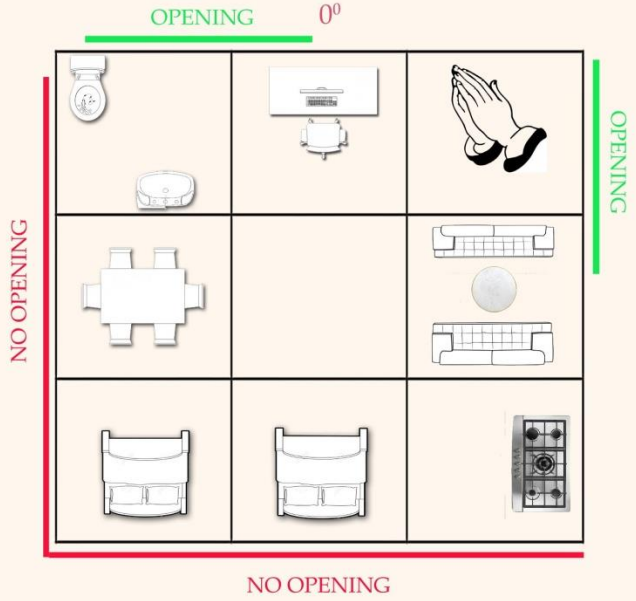

VASTU AARAMBH

WATER BORING & OVERHEAD TANK

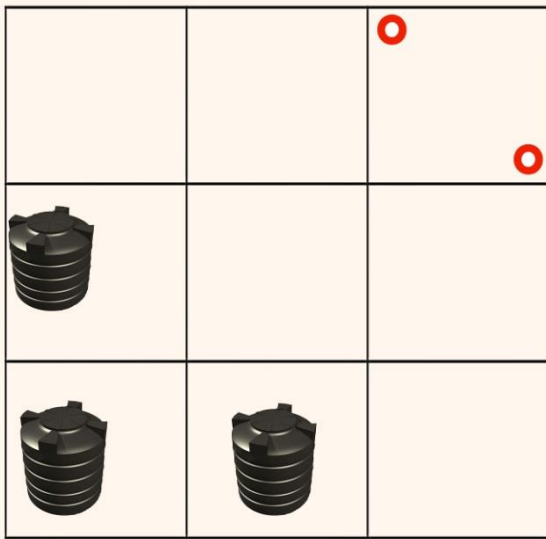

KITCHEN

N  
0°

VASTU AARAMBH

Option 2

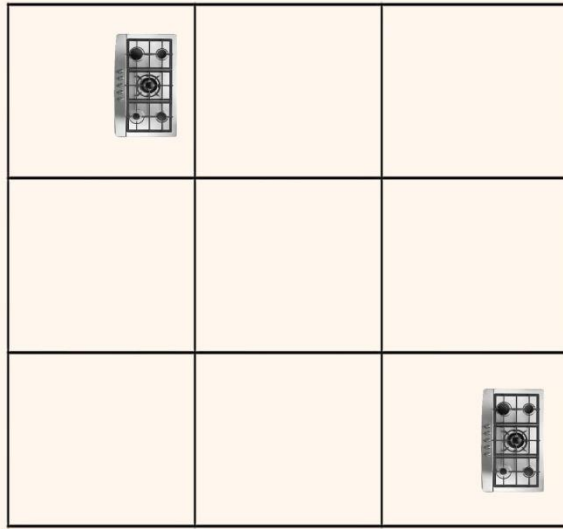

East facing  
stove in SE corner  
of house is  
best placement



Clockwise Stairs

N  
0°

VASTU AARAMBH

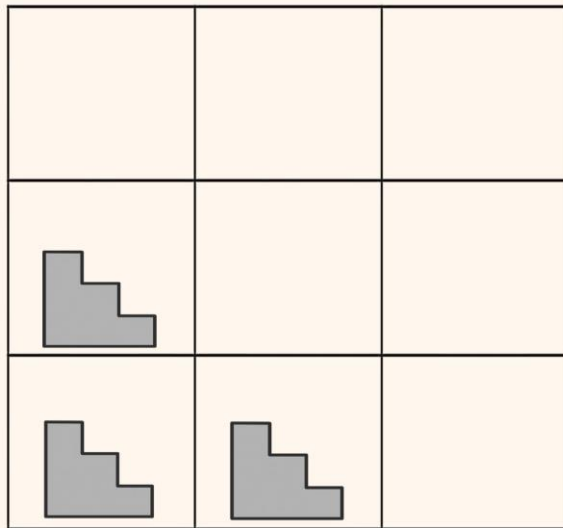

### Colour Placement

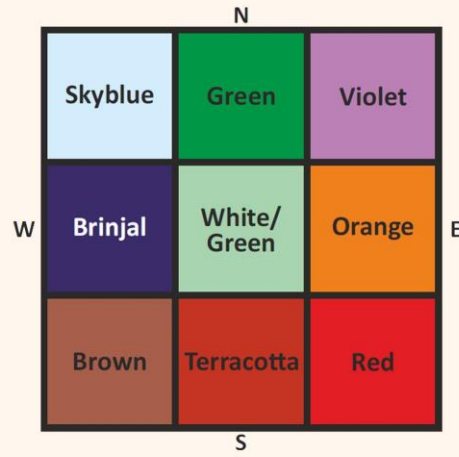

### FLOOR LEVELING

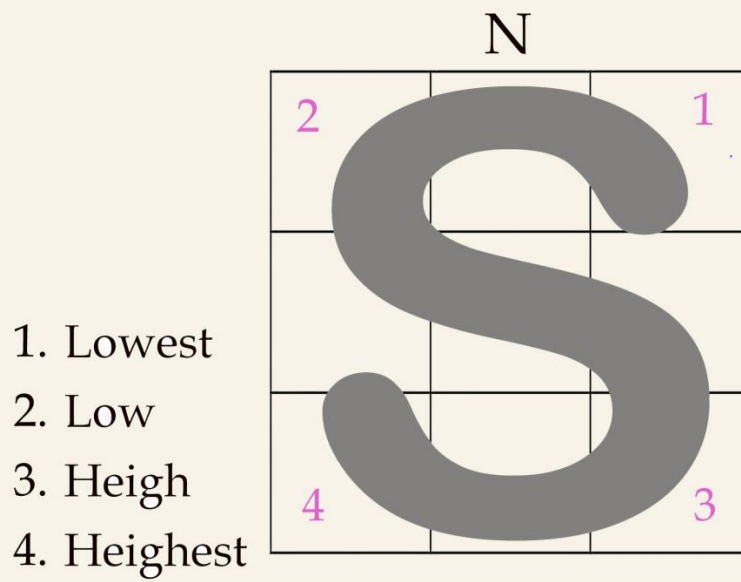

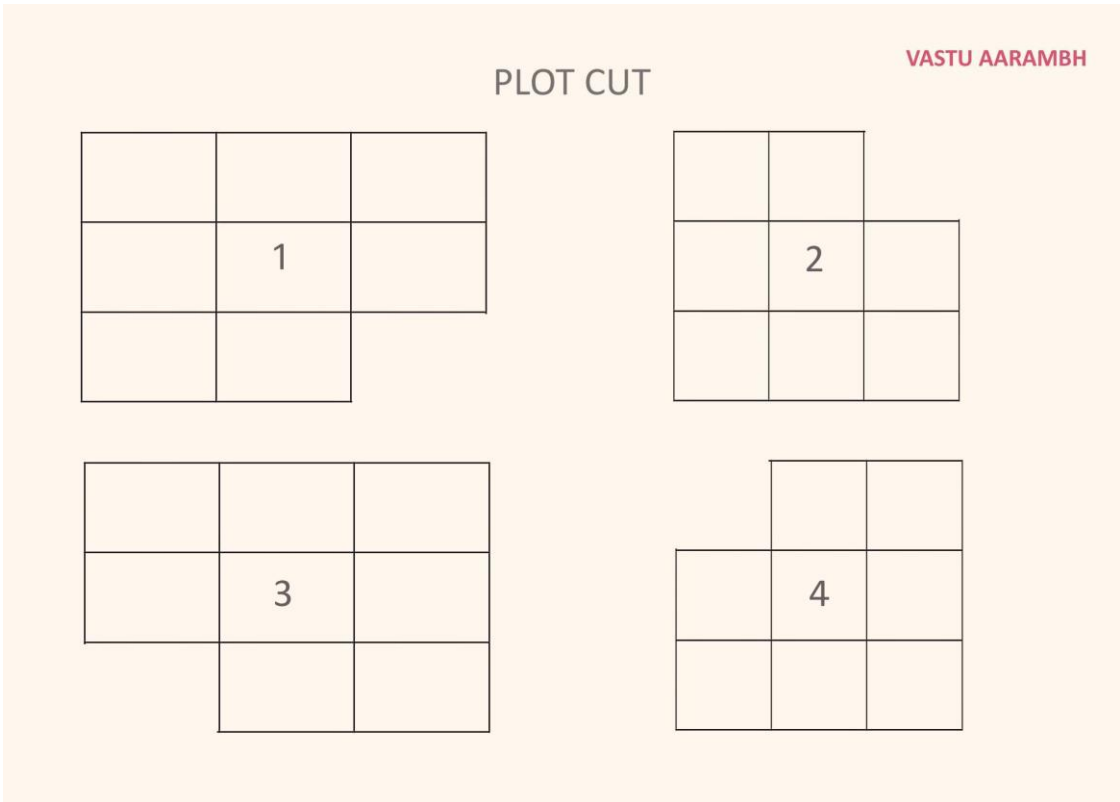
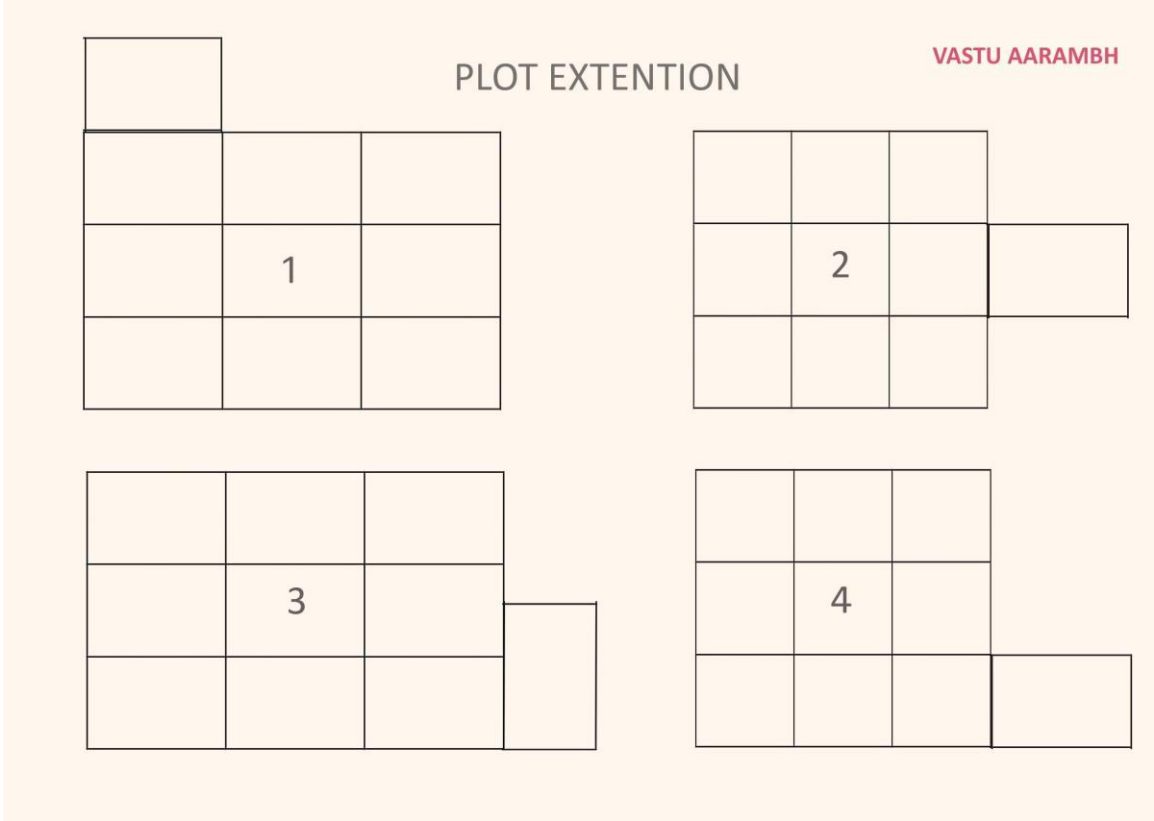

This is a very important aspect of any house. People start the day with offering prayers to the deity. Hence, this is a very positive zone and ideally is best placed in Northeast of the house. As we are familiar with the placement of Vastu Purush, North East represents the head of vastu purush and our prayers to God is mostly to seek wisdom and positivity in life. If Pooja room is elsewhere in the house it might or might not give its full energy in respect of Jupiter planet.

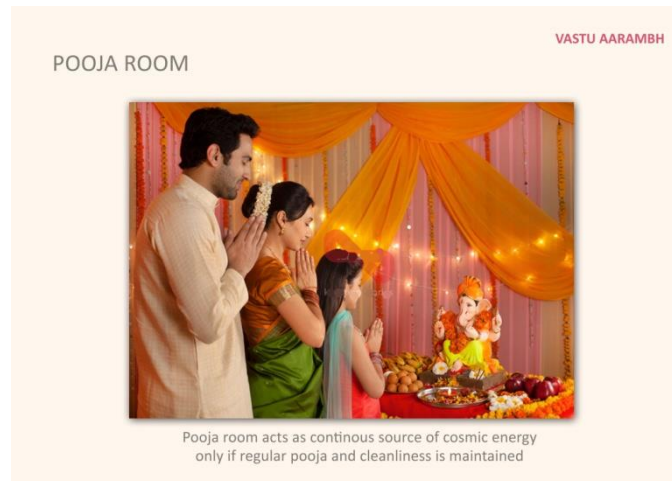

You can keep one murti of each God and not more than that. The size of the murti should be smaller than the size of your hand. Mandir in bedrooms is not recommended.

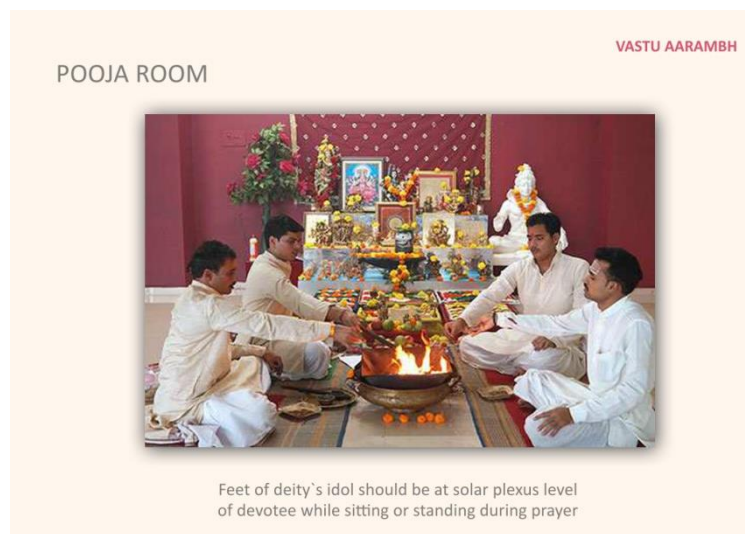

Worship room should not be made in the bedroom as it is control by Materialistic objects. Pooja should also be avoided in kitchen and in front of washroom also. We can keep study table in the Pooja room.

Only clean Idol or Yantra should be placed in Pooja room. The statue should not be more than 6 inches tall. If possible one should have separate Pooja room in the house and should always be kept neat clean and tidy. Use separate broom and cleaning cloth for the pooja room. You should not keep any waste material like brooms in the pooja room or near the pooja place.

Pictures of ancestors and Departed soul should not be kept in pooja room, they may be very departed dear and respectable but they cannot be compared with God and place along with them.

Dustbin is an object which you make use to throw all the useless things in your life. So, it is a symbol of useless things being thrown out from your life, that forms the basis on which it affects your life. Dustbins should not be at the entrance gate.



Medicines are very important part of our life style and one should really know where to keep medicine, the best zone is North East as it is the area that represents immunity and overall health.

All sorts of sharp corners in the house may cause depletion in the balanced energy flow. They can cause major imbalance and disturbance in the house. In general also sharp corners can be very harmful for the inhabitants as can cause hurt and injuries too.

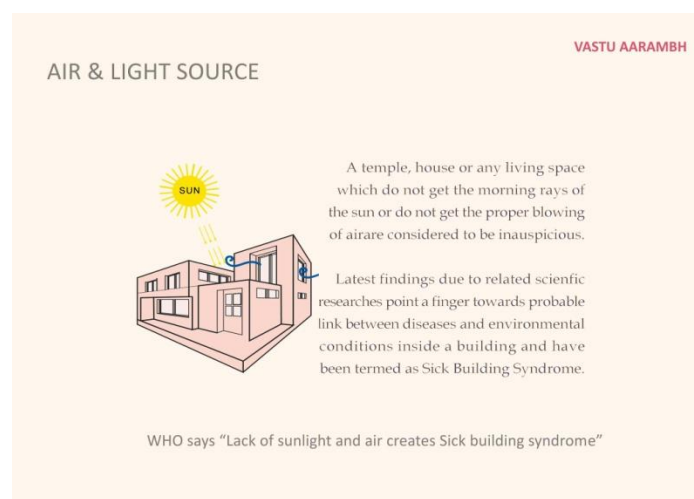
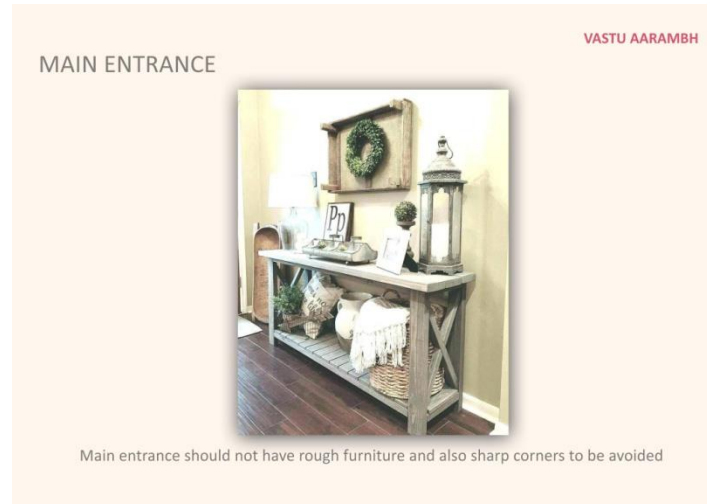

Beds made out of wood are the best so avoid iron beds. Placing the bed exactly opposite the door is not recommended, as it depletes the energy which further gives material disharmony and fear of death also.

Avoid keeping all electromagnetic equipment and gadgets in the bedroom if possible. It is best to sleep without any interference of electromagnetic radiation as it affects the sleep patterns. Power points or charging stations near bed create high level of electromagnetic radiation that can even create disturbances in your chakras, which is very difficult to repair.

## BEDS

VASTU AARAMBH



Bed side table should not have electric power stations

Avoid placing mirror in front of the bed

In couple bedroom, dress of double bed should be one long mattress. Two single mattress should be avoided, if you have two single mattress in the couple bedroom it might slowly ends up creating a rift between the couple.

## SCREEN REFLECTION

VASTU AARAMBH



TV/Computer screen should not be in front of bed

Television and computer in the bedroom also create tension and width between the couple so that's why we should try to keep them outside.

Picture of War, painting of ferocious birds and animals should also not be placed.

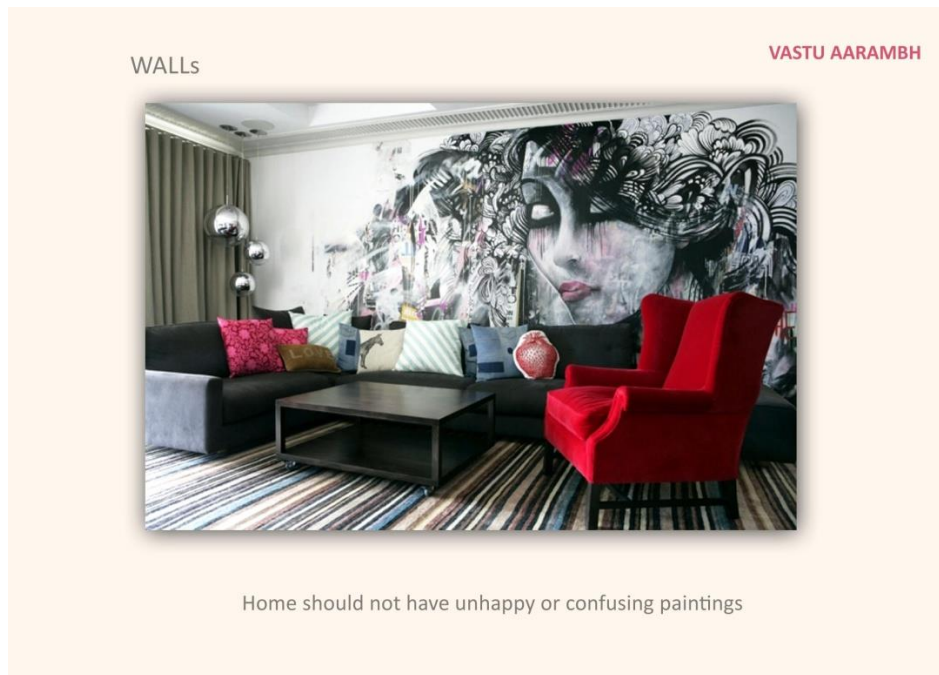

Avoid using very bright colours and try to use light colours for the bedroom.

Avoid irregular or odd shaped beds, rectangular beds are recommended. Even sharp geometry should be avoided near bed.

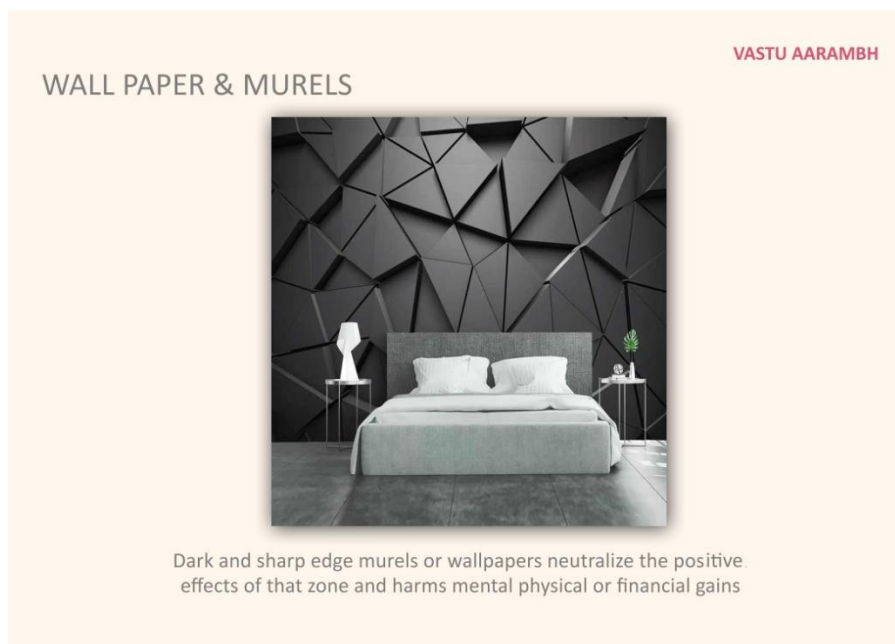

Color of the curtains of the house should be very light and sober. Colors like white, peach and light blue are the best choice. Rose pink is best suited for the bedroom of a couple as it represents love. Dark red should always be avoided in the bedroom as it symbolizes anger. Similarly, avoid black color in the bedroom.

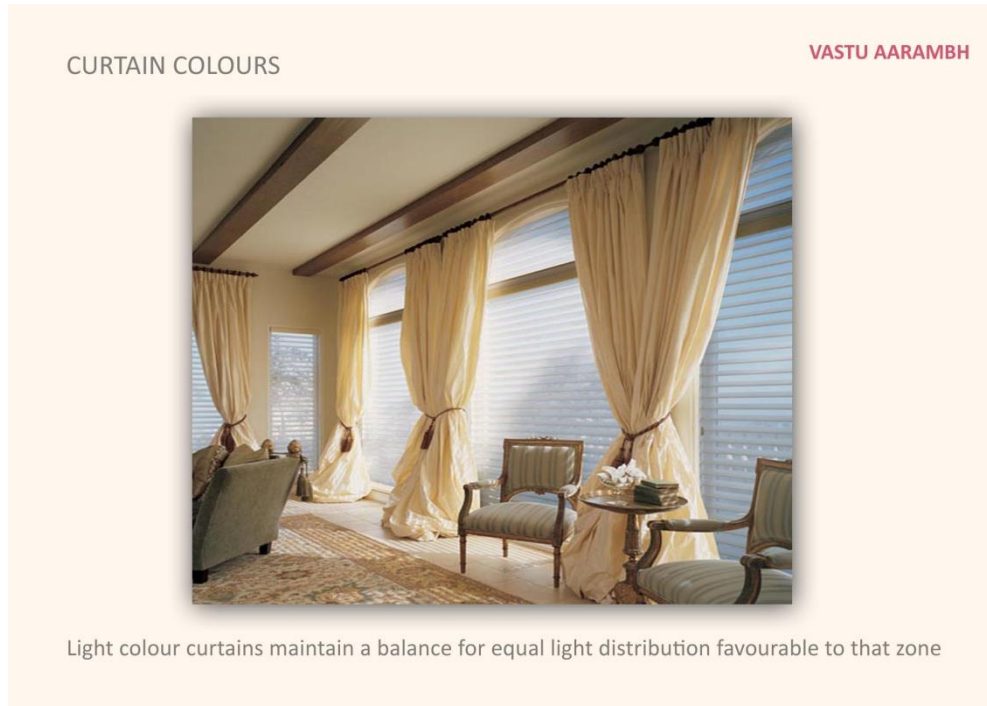

Living room chosen as per Vastu also add to the positivity and happiness. All the colors that symbolize progress and peace can be used in the living room. The best colors for living room curtains are beige, blue, yellow.

Apart from the curtain, Vastu for each room should also consider colors according to directions.

North-west facing rooms should have curtains in white color. The color white brings peace and freedom to the one who remains in the room. It also lets sufficient daylight pass through which is important for positivity.

The curtains of North facing rooms should be light green in color. Green is the color of Mercury which influences the knowledge aspect of the residents.

The rooms facing towards the West should have curtains of grey color. It brings in satisfaction and fulfilment amongst the inhabitants.

Southeast facing rooms should have curtains of red or pink color to invoke love and passion and Northeast facing rooms should have curtains of violet color to enhance optimism, self-confidence and joy.

Practically speaking ideal directions for placing a shoe rack are the near entrance gate. Open shoe racks should not be placed in north, south-east and east directions. If the house entrance is in the north or east, then do not place open shoe rack near the area. If it is not possible, then place it outside the house.

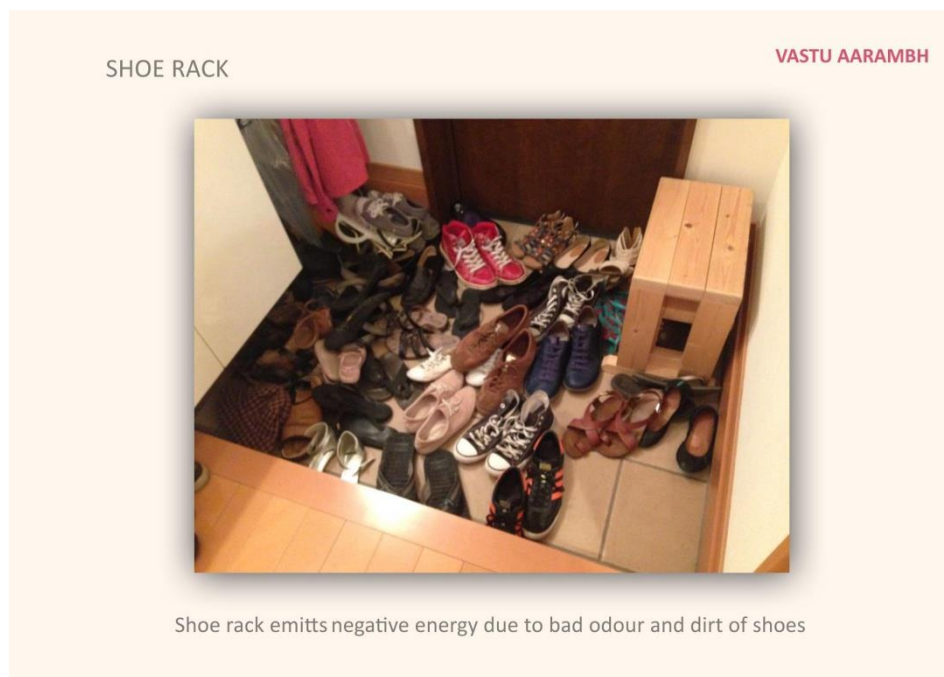

Shoe cabinets must not be placed in the bedroom, kitchen or prayer room. Placing the shoe in the bedroom can have a negative impact on your married life. Cluttering the house with open shoe rack especially near the main door could lead to family feuds. Arrange the shoes properly and never leave them in a hanging or entangled state which tends to attract negative energies.

Closed shoe cabinets, which do not allow negativity to spread, are recommended.

## SHOE RACK

VASTU AARAMBH



Shoe rack should be covered completely, it should not produce bad image or bad smell

## Family photos

Your family photos represent the good times and memories spent together. The ideal place for your pictures is South West, West direction of the house or your room.

## FAMILY PHOTOS

VASTU AARAMBH



Family photos should be in West direction of house

Photos of the ancestors should be placed in the south direction of your house. Northeast direction for ancestors Pictures is not recommended.

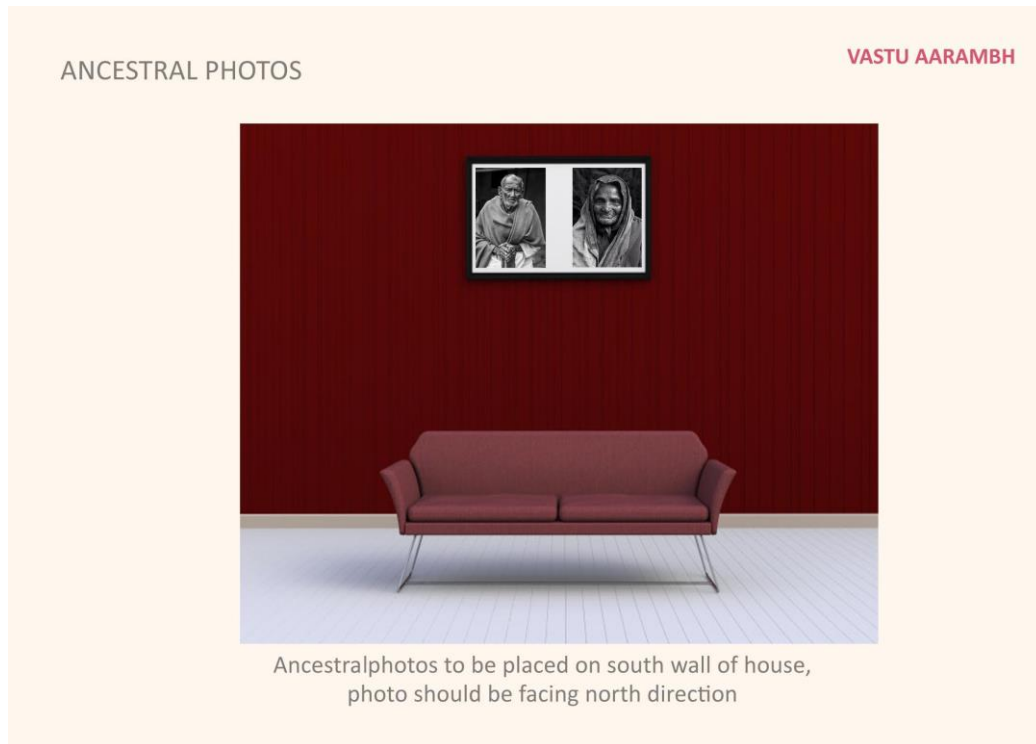

Northwest is a zone for relationships and attraction, pictures of couples and newly wedded can be placed here. Please do not place family pictures in the south east direction of the house, it may cause heated arguments and disturbance in the relationships.

KITCHEN STOVE & TAP

VASTU AARAMBH



Kitchen slab should not have stove as well as water tap in a straight line

Kitchen slab and tap should never be in one line. You should not keep Fire and Water at the same place as It disturbs both the elements and crates problems. It should be as far as possible, best is to give a gap in between the slab or keep it on another direction.

KITCHEN STOVE & TAP

VASTU AARAMBH



Kitchen slab should not have stove as well as water tap in a straight line